

## EA II – Installation

### BS:8539

#### Installer:

The competence of installer must be proven before installation has commenced as this ensure that anchors are being installed as per manufacturers guidelines. I.e., using the correct setting tool and correct cleaning procedures of drilled hole.

We at fischer can help installers and supervisors gain competence by conducting toolbox talks. We also have an online toolbox talk training portal which allows you to watch a video then complete a short test at the end. See link to Online training portal: <https://www.fischer.co.uk/en-gb/training/training-videos>

Once successfully completed you shall receive a certificate. This certificate proves installer is competent.

#### Supervisor:

Anchor installation must be conducted under supervision and relevant CFA installation form filled out during installation must be completed. Must also ensure that all the correct procedures and tools are conducted during installation.

### EA II – Setting tool

#### Setting tool EMS Plus



EHS Plus with hand impact protection for your safety and embossing tool

EA-ST

Item	Item No.	Match
EHS M 6 x 25/30 Plus	044630	EA II M 6 x 25, EA II M 6 x 30
EHS M 8 x 25/30 Plus	044631	EA II M 8 x 25, EA II M 8 x 30
EHS M 8 x 40 Plus	044632	EA II M 8 x 40
EHS M 10 x 25/30 Plus	048487	EA II M 10 x 25, EA II M 10 x 30
EHS M 12 x 25 Plus	532568	EA II M 12 x 25
EHS M 10 x 40 Plus	044633	EA II M 10 x 40
EHS M 12 x 50 Plus	044634	EA II M 12 x 50, EA II M 12 x 50 D
EHS M 16 x 65 Plus	044635	EA II M 16 x 65
EHS M 20 x 80 Plus	044636	EA II M 20 x 80
EA-ST 12	504585	EA M 12 x 50 N D

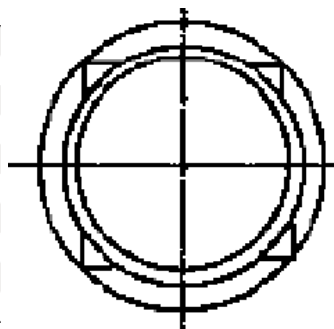

Note: Machine setting tool EMS SDS attachment can be used also to set and expand anchor but does NOT create a setting mark.

### ETA Approval

#### Installation:

- Anchor installation carried out by appropriately qualified personnel and under the supervision of the person responsible for technical matters of the site
- Create drill hole with hammer drill or with hollow drill and vacuum cleaner
- The anchor may only be used once
- In case of aborted hole: New hole must be drilled at a minimum distance of twice the depth of the aborted hole or closer, if the hole is filled with a high strength mortar (e.g. FIS EM Plus, FIS SB or FIS V Plus) and only if the hole is not in the direction of the oblique tensile or shear load
- Anchor expansion by impact using the setting tools given in Annex A 4. The anchor is properly set, if the stop of the setting tool reaches the expansion sleeve. The manual setting tool with installation control leaves a visible mark on the sleeve, as illustrated in Annex A 4 and B 4

**Expansion of anchor must be conducted via corresponding setting tool. If another tool is used to expand anchor then ETA is not valid.**